

ILLOURA
HOUSE

ST.KILDA RD



TYPE T4.A

Apt. No. 0604, 0704, 0804, 0904,
1004, 1104, 1204, 1304, 1404, 1504

2 Bedrooms
2 Bathrooms

Internal	77 m ²
External	8 m ²
Total	85 m ²

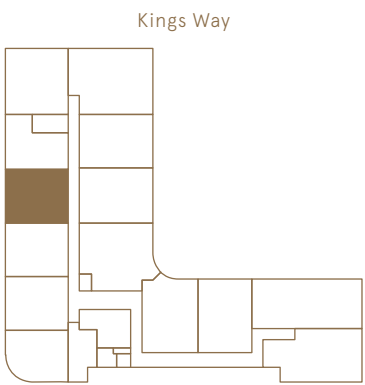

DISCLAIMER All images, artists’ impressions, diagrams, photographs, views and design features are for marketing purposes only and subject to change. Dimensions and any areas shown or implied are indicative only and subject to change. Areas have been measured in accordance with the Property Council of Australia method of measurement guidelines. Facade configuration may vary to this plan and varies on each floor level – refer to selected floor level plan for general facade configuration. Operable window, sliding door locations and sizes are indicative and subject to change. Paving and floor patterns are indicative and subject to change. All internal and external furniture ,whitegoods are not included in the contract (unless otherwise stated in the specifications or in the contract) and any layouts are shown as a guide only. The purchasers are advised to rely only on the contract and its contents and to carefully examine and compare with the contract, all other marketing materials and documents provided before signing the contract. *Shaded area of glazing indicates obfuscated glazing, louvres or any other window treatment determined by the developer.

